

Reflex

Passive Infrared Detector INSTALLATION INSTRUCTIONS



THANK YOU FOR VOTING TEXECOM
Ask your distributor today for the new Texecom full colour Product Guide.

Texecom
www.texe.com

INS 156-4

QUALITY ASSURANCE



Certificate Number: FM 35285



WARRANTY

10 year replacement warranty.

The Reflex is designed to detect the movement of an intruder and activate an alarm control panel. As the Reflex is not a complete alarm system, but only a part thereof, Texecom cannot accept responsibility or liability for any damages whatsoever based on a claim that the Reflex failed to function correctly.

Due to our policy of continuous improvement Texecom reserves the right to change specification without prior notice. All specifications are measured at 20°C (68°F).

Document Ref: REF/EU/1.0-7
© 1994 - 2004 Texecom Ltd

1 PHYSICAL

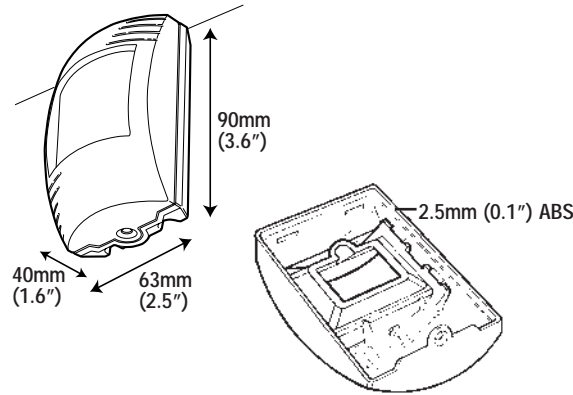

2 ENVIRONMENTAL

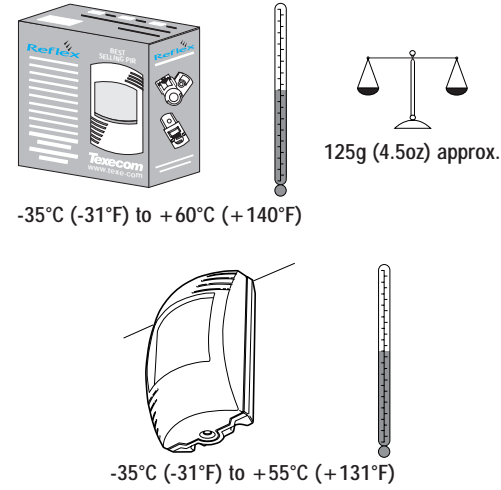

3 FALSE ALARM PROTECTION

- Design:** Noise reduction circuits with maximum ground plane.
- RF Immunity:** No false alarms from 80MHz to 1GHz at 50V/m, equivalent to a 700W uniform transmitter at 3m (10ft). Complies with BS EN 61000-4-3 : 1997.
- Electrostatic Discharge:** No false alarm up to 8kV. Complies with BS EN 61000-4-2 : 1995.
- Fast Transient Immunity:** No false alarm up to ±1kV. Complies with BS EN 61000-4-4 : 1995.
- High Energy Transient Immunity:** No false alarm up to ±1kV. Complies with BS EN 61000-4-5 : 1995.
- Conducted RF Susceptibility:** No false alarms at 10Vrms. Complies with BS EN 61000-4-6 : 1996.
- Conducted Emissions:** Complies with EN 55022 Class B.
- Radiated Emissions:** Complies with EN 55022 Class B.
- EMC:** Independently certified to EN 50130-4 : 1996.
- Pulse Count:** Adjustable Pulse Count. Internal link to select.

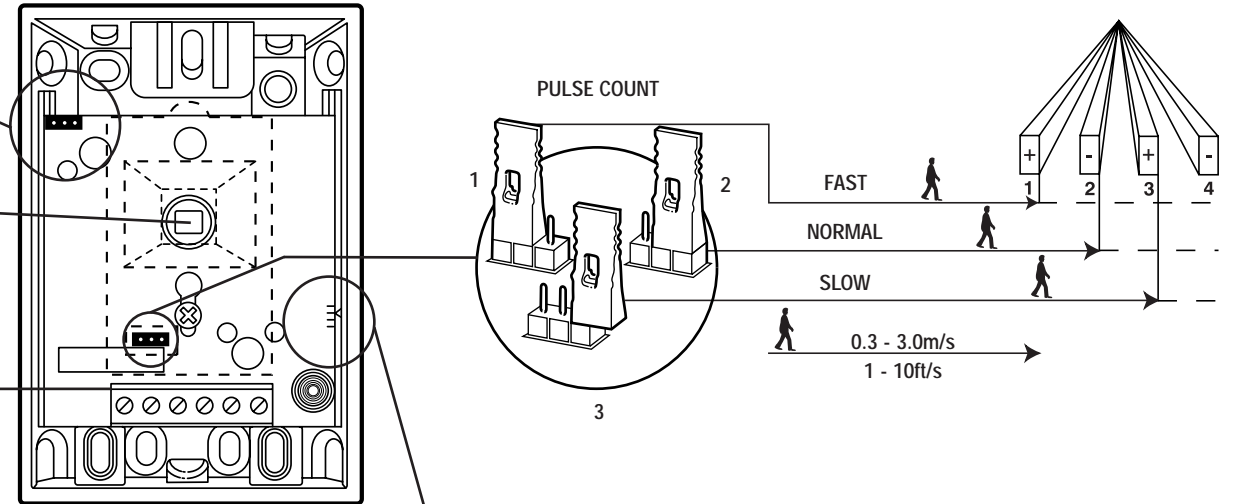
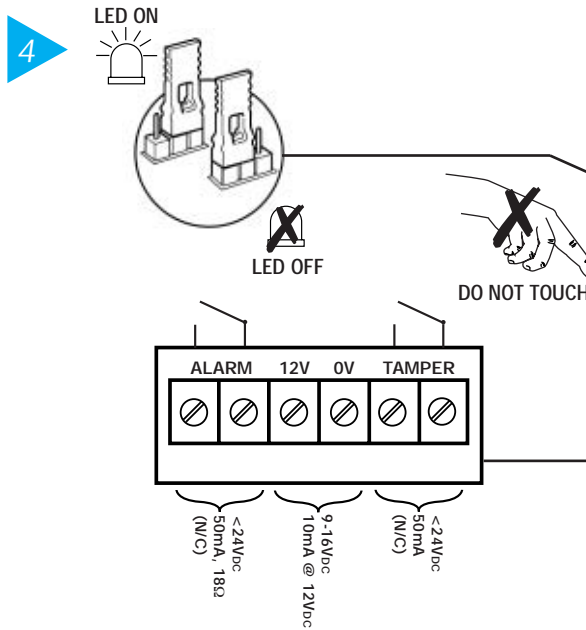

5 COVERAGE AND PICK-UP

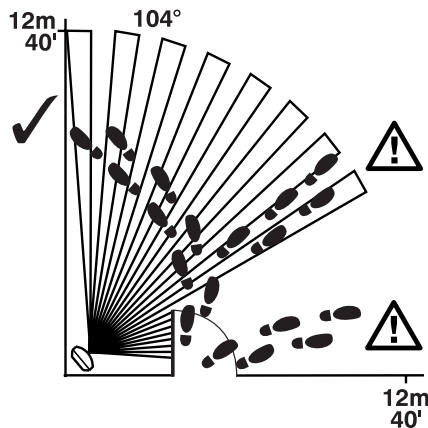

6 ANGLING THE DETECTOR

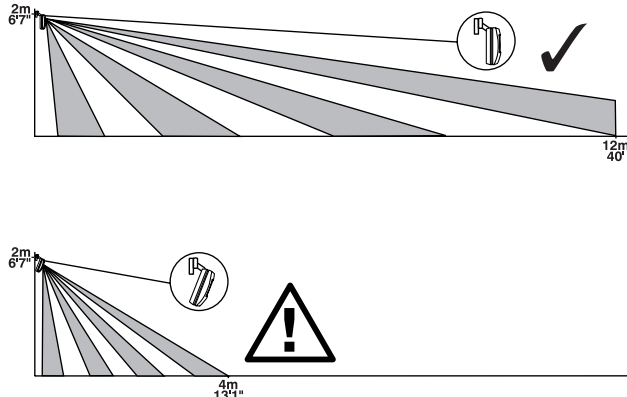

7 MOUNTING HEIGHT AND SETTINGS

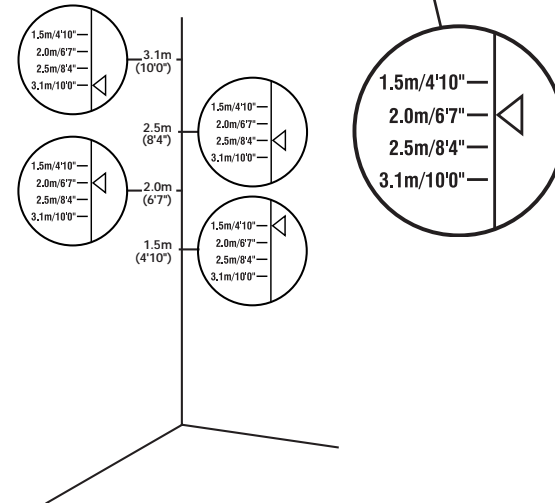

8 COVERAGE AT 2m

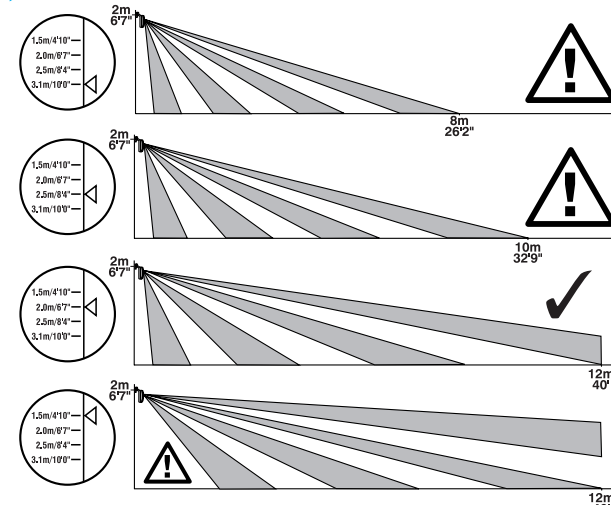

9 LENS SELECTION

See Mounting Height Diagram (Section 7)

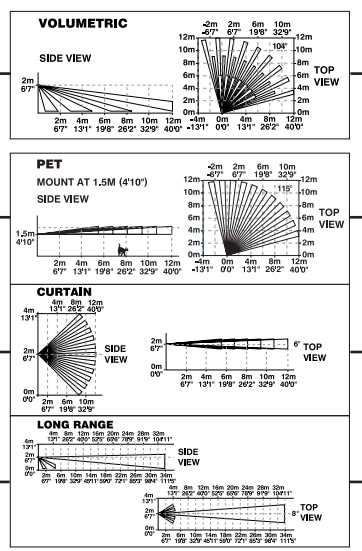

- 1.5m/4'10"
- 2.0m/6'7"
- 2.5m/8'4"
- 3.1m/10'0"

10 CHANGING LENSES

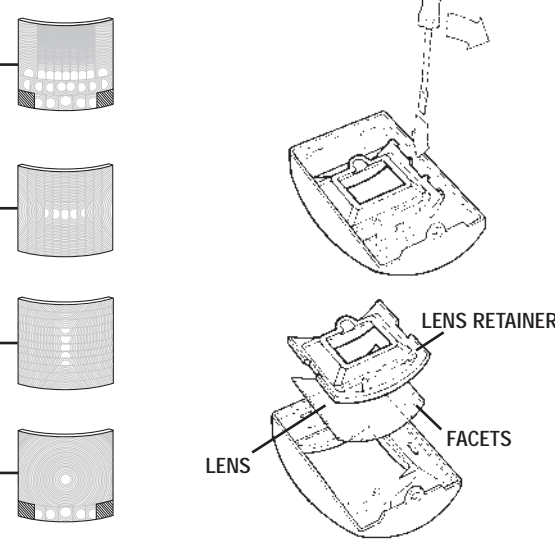

11 MOUNTING THE REFLEX

For indoor use only

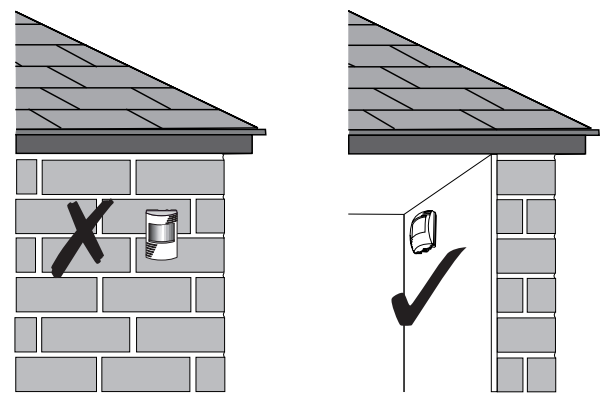

12 MOUNTING THE REFLEX

Mount on a stable surface

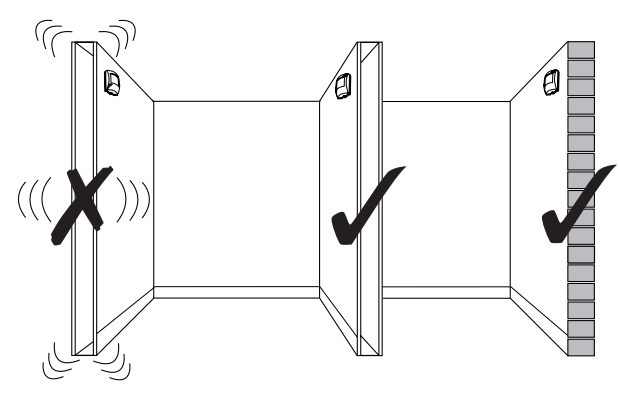

13 WIRING

Do not run cable parallel to mains wiring

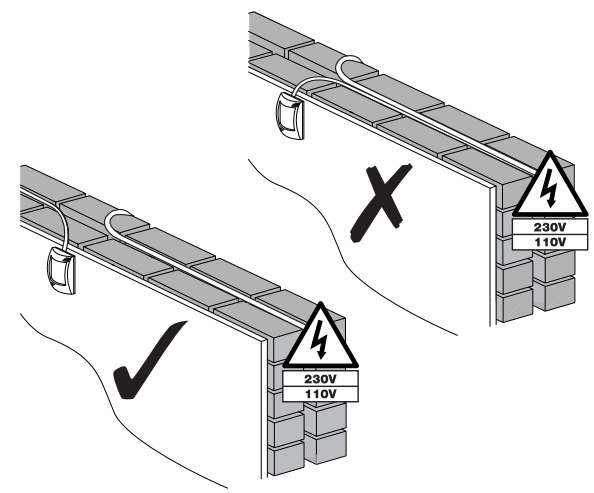

14 CHOOSING A LOCATION

Avoid common false alarm sources

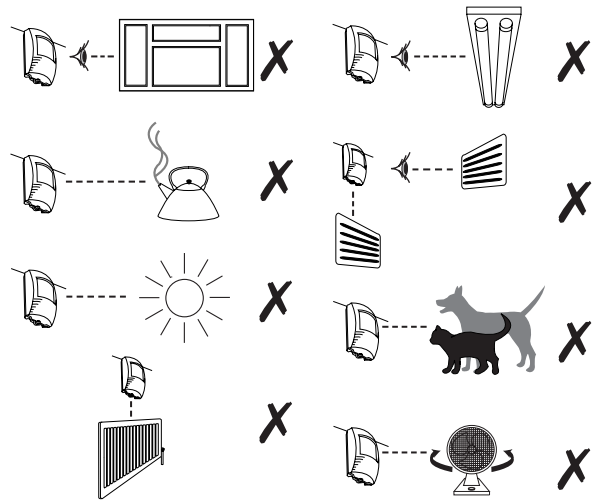

15 DETECTOR KNOCKOUTS

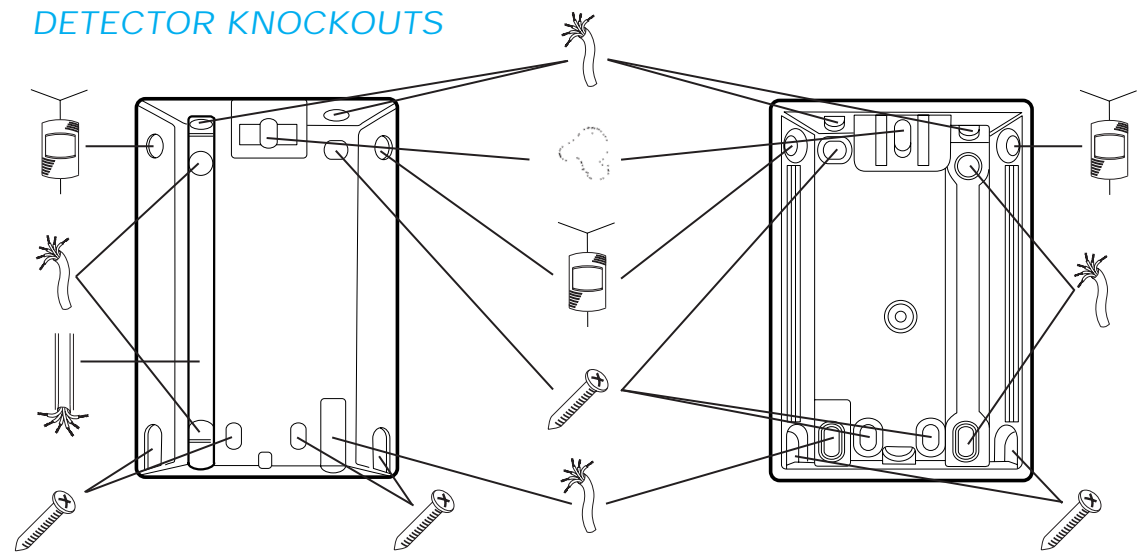

16 CEILING MOUNT BRACKET

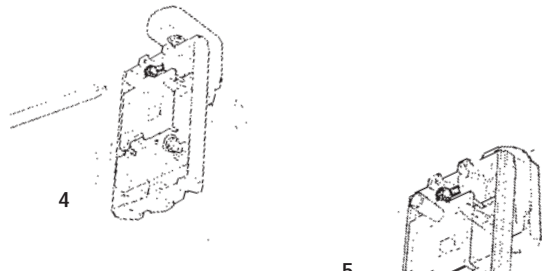
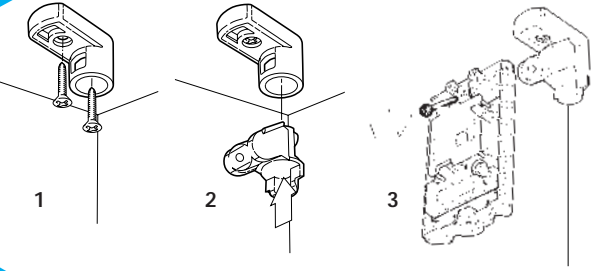

18 MOUNTING WITHOUT BRACKETS

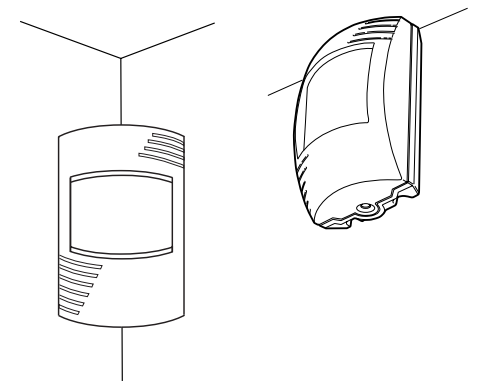

17 WALL MOUNT BRACKET

